

Comment utiliser votre Scoot ?

Outils nécessaires :

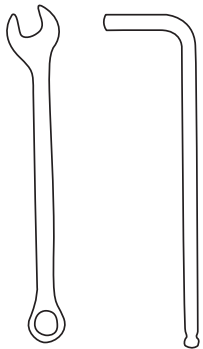

Matériel fourni :

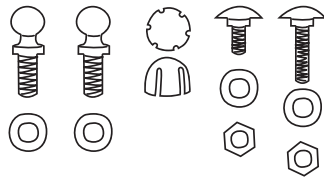

Veiller à ce que la meuleuse soit hors tension au moment du montage du Scoot



Flashez le QR code ou rendez-vous sur www.autourdubeton.com/type/scoot-machines/ pour découvrir l'installation en vidéo !

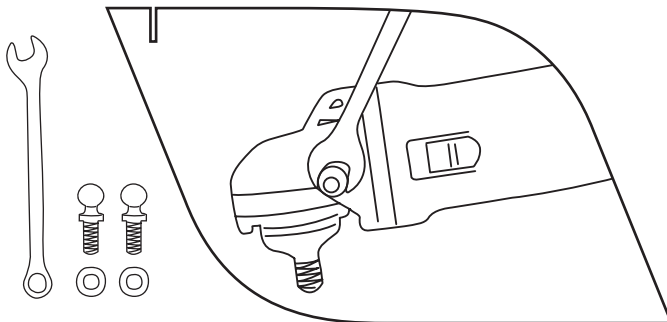

Visser les deux rotules de chaque côté de la meuleuse à l'aide d'une clé.

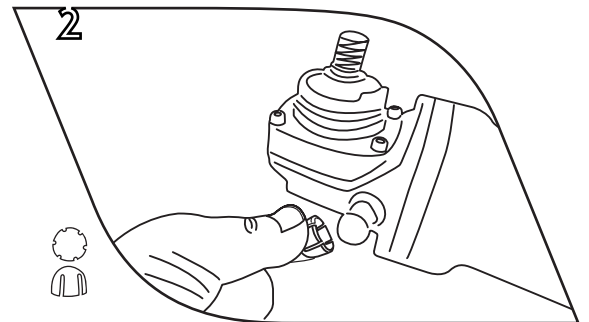

Poser les deux bagues plastique sur les deux rotules.

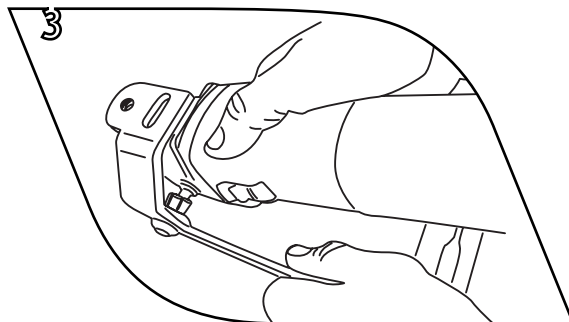

Clipser le Scoot de chaque côté de la meuleuse.

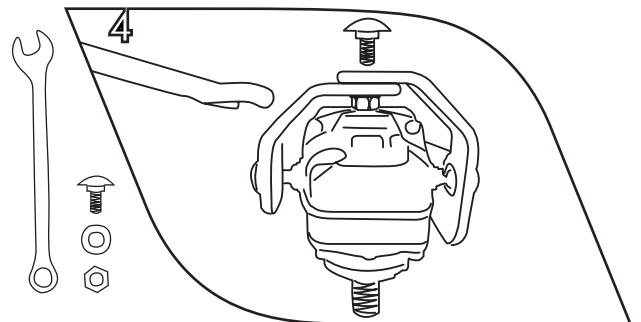

Assembler à l'aide de la vis courte les deux parties du Scoot.

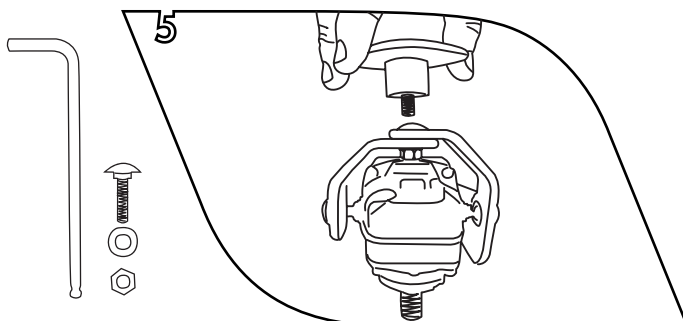

Visser sur le dessus le pommeau avec l'amortisseur « silent block ».

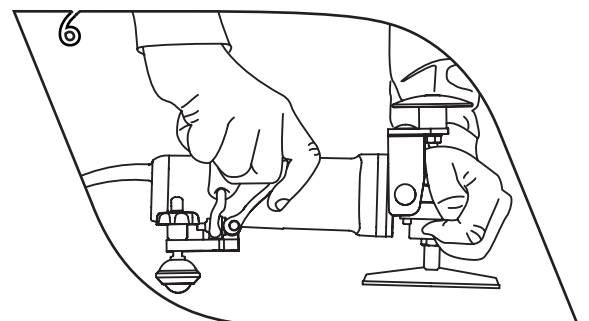

La dernière étape est de calibrer l'assemblage meuleuse/ Scoot :

- placez l'ensemble sur une surface plane,
- pressez la tête de la meuleuse d'une main,
- relâchez le frein,
- placez la cale contre l'arrière de la meuleuse,
- ré-enclenchez le frein.

How to use your Scoot?

Required tools:

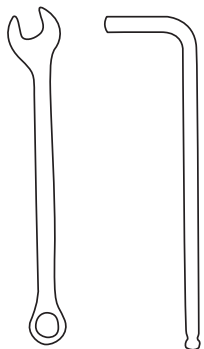

Equipement needed:

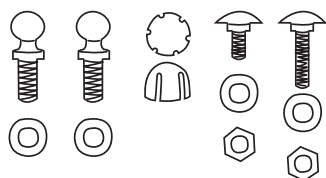

Make sure that your grinder is unplugged when you proceed to the Scoot assembly



Flash the QR code or visit our website www.autourdubeton.com/type/scoot-machines/ to consult the installation online!

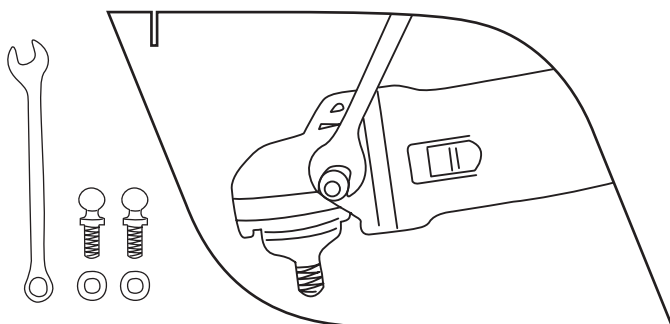

Screw the spherical bearings on each side of the grinder using a spanner.

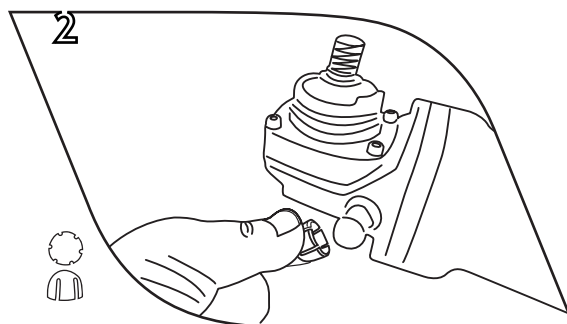

Feet the two plastic rings on both spherical bearings.

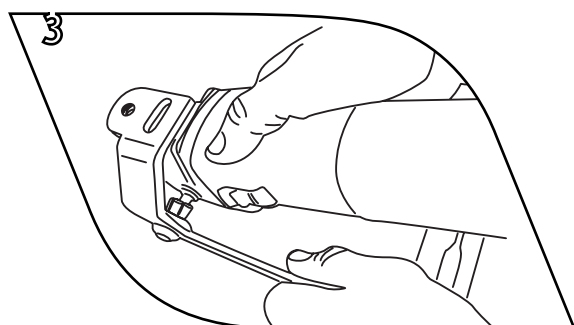

Clip the Scoot on each side of the grinder.

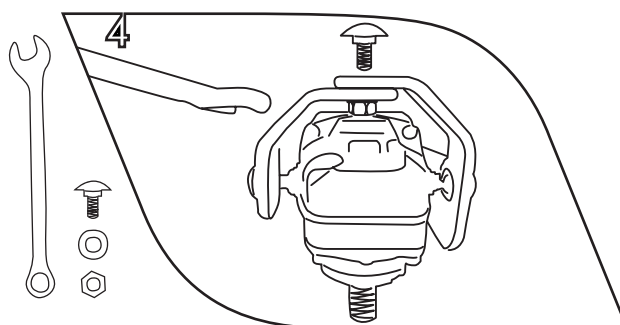

Use the short screw to assemble the two parts of the Scoot.

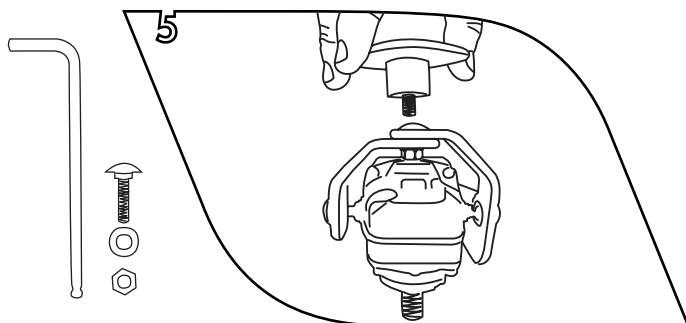

Screw the handle with shock absorber on top.

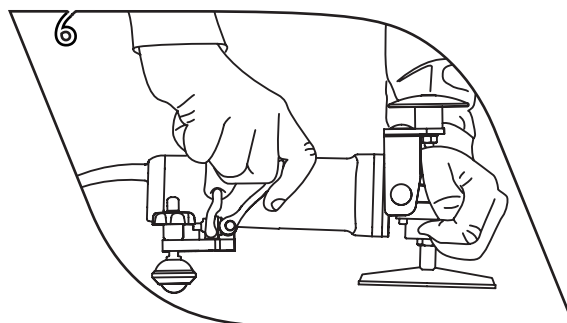

The last step is to calibrate the Scoot/grinder assembly:

- Place on a flat surface,
- Press the head of your grinder with one hand,
- Release the break,
- Position the block against the back of your grinder,
- Re-clamp the break.